

CO-OPERATIVE BUILDING

**Project:**  
 Design and Supervision for New Extension and Development for Existing Building at Dahed Abdulla Salem Co-operative Society

**Owner:**  
 Dahed Abdulla Salem Co-operative Society

**Location:**  
 Kuwait

**Description:**

- **Project Area:**  
1500 sq.mts
- **Project Duration:**  
July 2009 – Present
- **Project Element:**  
It was a 1500 sq.mts existing building which is divided into two parts of work. First part was the redevelopment of the existing building for its main supermarket while the second part works for the extension building and restaurants.

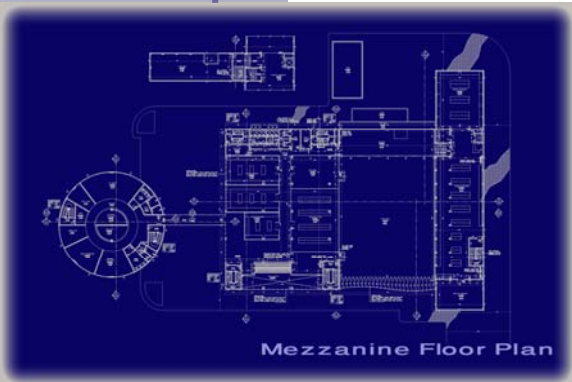

**Scope of Works:**

The F&M Consultant Engineers furnished the:

- Design
- License Approval
- Tender Documents
- Supervision

